A photograph of a modern building with a large glass facade and a blue sky with clouds. The building has a dark, metallic-looking exterior on the left and a large glass section on the right. The sky is bright blue with scattered white clouds. In the foreground, there is a paved area with a row of small, dark, cylindrical bollards. The overall scene is bright and clear.

DiGRAA 2026 Delegate Guide



The University of the Sunshine Coast acknowledges the Traditional Custodians of the land on which we live, work and study. We pay our respects to local Indigenous Elders past, present and emerging and recognises the strength, resilience and capacity of all Aboriginal and Torres Strait Islander people.





DiGRAA 2026 Special Thanks

- UniSC Moreton Bay Events Team (AKA the incredible Haylee Jack and Jess Jeffress).
- DVC Research and Innovation Professor Ross Young and our internal ACCELERATE grant.
- School of Business and Creative Industries Dean Professor Mark Loon and former Dean Professor Lorelle Frazer.
- Engage Research Lab.

DiGRAA 2026 Organising Committee

- Dr Jacqueline Burgess
- Dr Alexander Muscat
- Dr Kirsty Redgen
- Professor Christian Jones
- Arden Sedmak
- Jana Voelker
- Tiana Toussaint
- Jesse Clement



Welcome to UniSC!

- UniSC is a young, community focused university founded in 1996.
- A member of the Regional Universities Network, UniSC has Queensland campuses stretching from Hervey Bay in the north to Moreton Bay in the south.
- UniSC is the world's only university with campuses on three connecting UNESCO biosphere reserves.
- We are delighted to welcome you to Queensland's newest university campus at Moreton Bay and the first DiGRAA to be held outside of a capital city.



Location

- DiGRAA 2026 will be hosted at UniSC Moreton Bay in Petrie, the City of Moreton Bay, QLD on February 9, 10 and 11.
- We recommend interstate delegates fly into Brisbane airport.
- There is a [train](#) from Brisbane Airport to Brisbane Central station via Fortitude Valley .
- You can also book airport transfers with [Conxion](#) and [Redcliffe Ezy Airport Transfers](#).
- We strongly recommend all delegates arrive by train to the conference venue each day as UniSC Moreton Bay is a very short walk from Petrie Station.

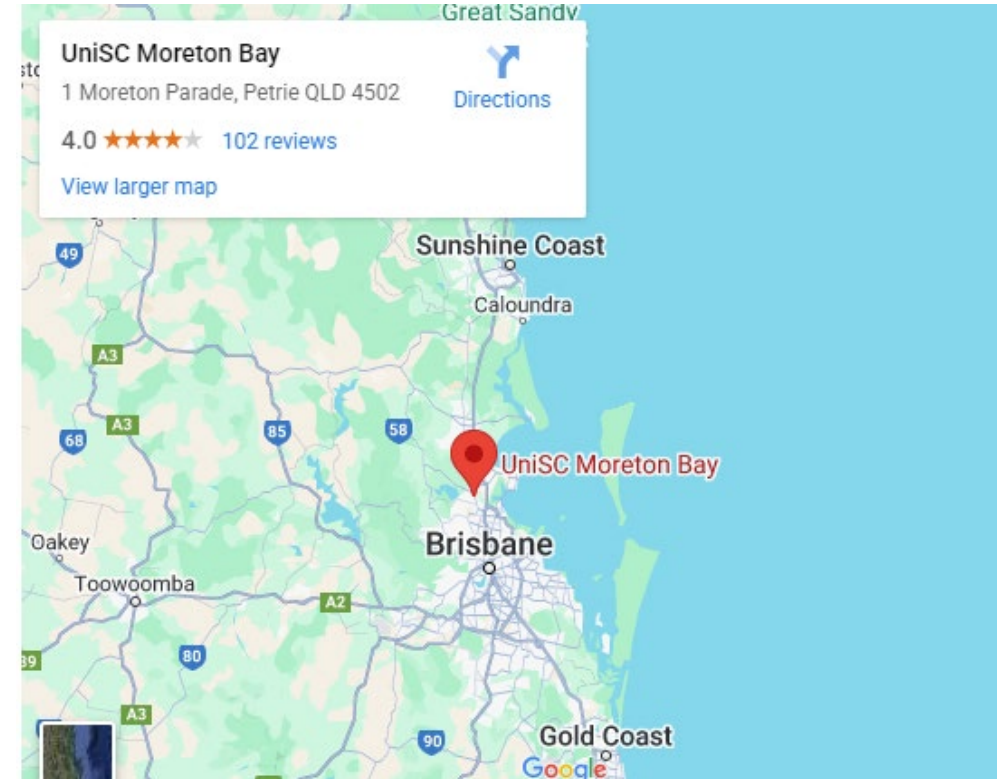

Where to Stay in Moreton Bay

- We strongly recommend delegates stay on the train lines to UniSC Moreton Bay. There is virtually no accommodation in Petrie.
- The Brisbane CBD near Central Station and Fortitude Valley would likely be the most convenient locations.
- For those who want to stay near the beach, we suggest Redcliffe and the surrounds.



Getting to UniSC Moreton Bay

- Petrie Station is a 29-minute journey from Brisbane Central Station (pictured) and a 27-minute journey from Fortitude Valley Station on the Caboolture and Springfield/Redcliffe Peninsula Lines.
- If staying in Redcliffe, there is a bus, or you could make your way to Kippa-Ring station via bus or Uber and take the train from there to Petrie Station. Kippa-Ring Station to Petrie Station is a 16-minute journey on the Springfield/Redcliffe Peninsula Lines.
- You can use [Translink's Journey Planner](#) or Google Maps to plan your route.
- Public transport is currently 50 cents per ride in Queensland.
- You can use your contactless Visa, Mastercard and American Express debit or credit cards, including those in a digital wallet, [to pay](#) for trains and buses in Brisbane and Moreton Bay.

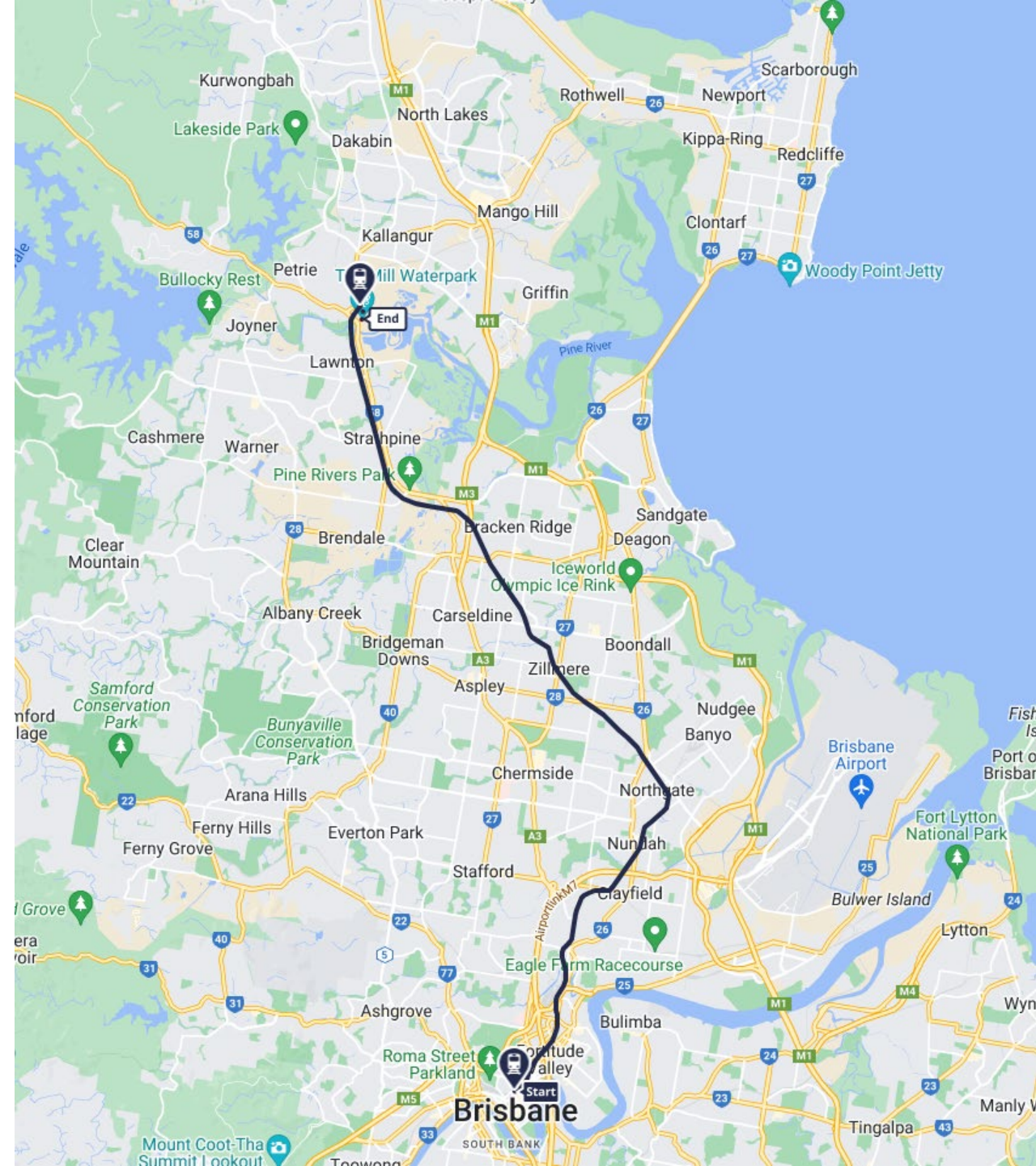

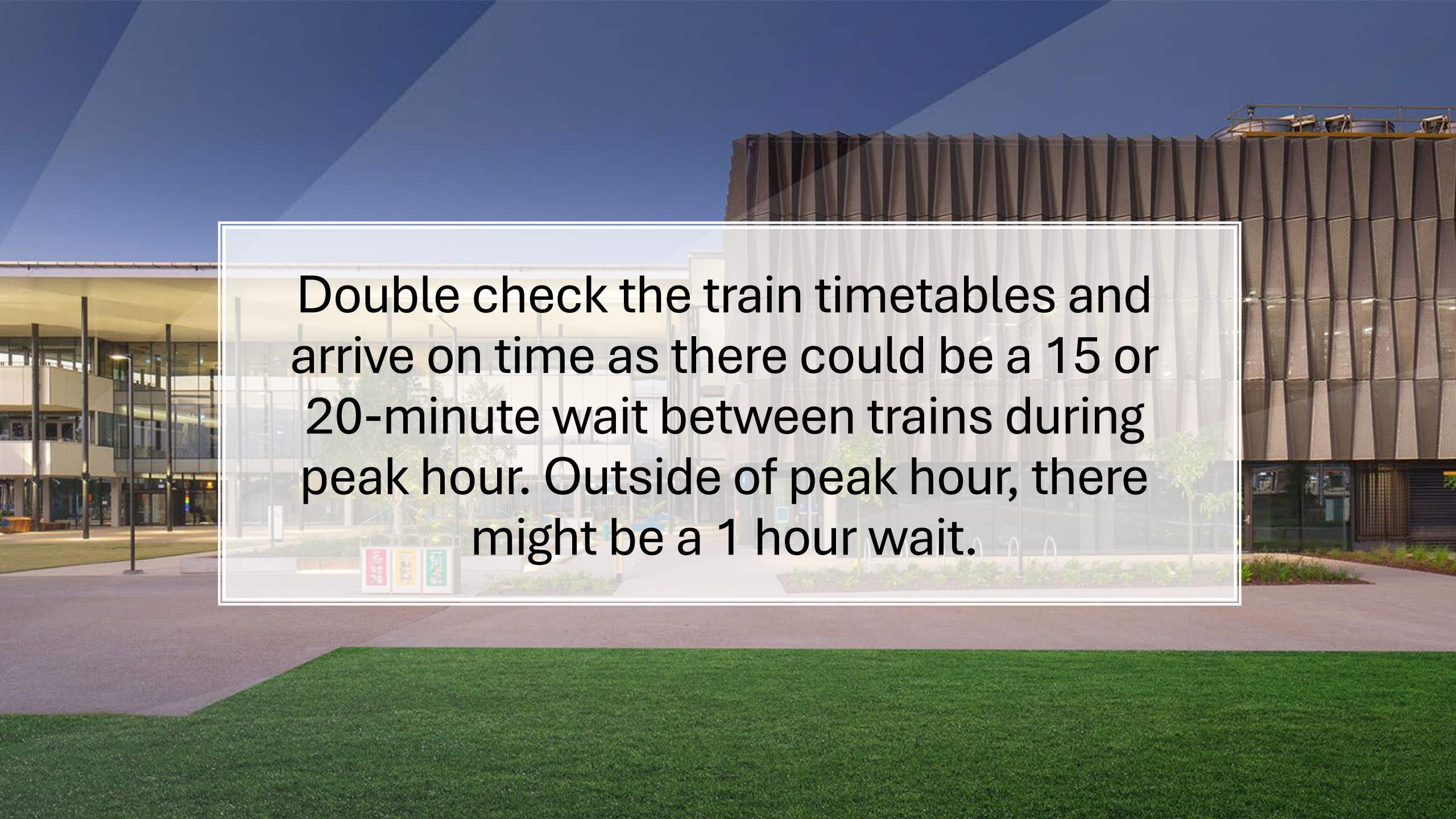
A photograph of a modern building at dusk. The building features a prominent section with a dark, vertically-slatted facade. To the left, a lower section of the building has large glass windows and a covered walkway. The foreground consists of a green lawn and a paved plaza. A semi-transparent white box with a thin black border is centered over the image, containing text.

Double check the train timetables and arrive on time as there could be a 15 or 20-minute wait between trains during peak hour. Outside of peak hour, there might be a 1 hour wait.

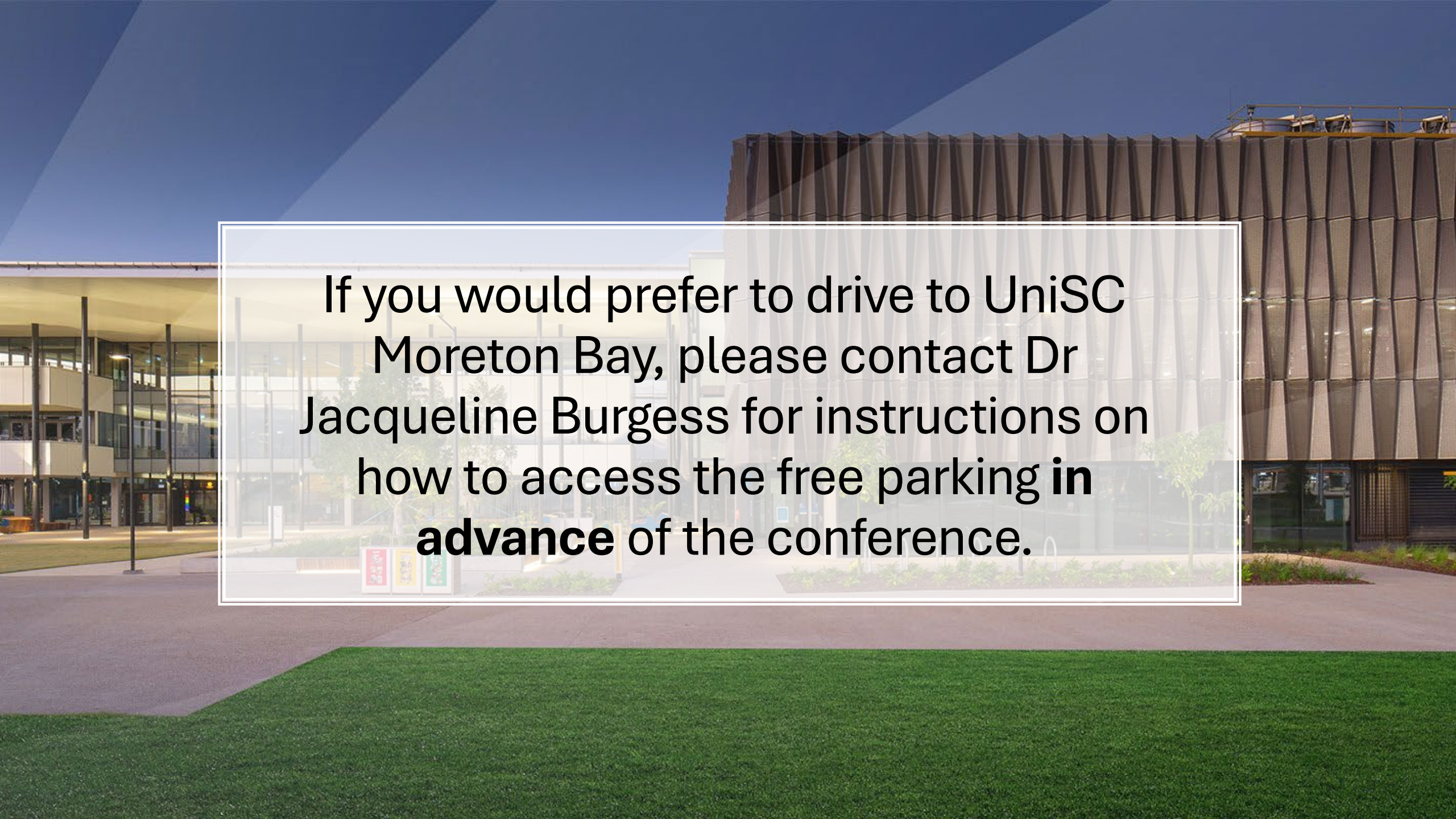
The background image shows a modern university building with a distinctive facade of vertical, ribbed panels. To the left, a lower building with large glass windows is visible. In the foreground, there is a well-maintained green lawn and a paved walkway. The sky is clear and blue.

If you would prefer to drive to UniSC
Moreton Bay, please contact Dr
Jacqueline Burgess for instructions on
how to access the free parking **in
advance** of the conference.

Arriving at UniSC Moreton Bay

- Once you leave Petrie Station head across the road, turn right and then turn left into Bribie Circuit.
- Cross the grassy area and head to the largest building: our A1 Foundational Building. The conference will be hosted in the Auditorium.



North



UniSC Moreton Bay A1 Foundation Building

- Once inside, follow the path indicated by the red arrows to the Auditorium. Registration will be outside.
- Ignore any stairs and elevators! The conference is in the Auditorium: G.23 on the ground floor. Registration will be outside.
- Look out for the coffee shop to the left when you enter.
- We will have volunteers around if you get lost.

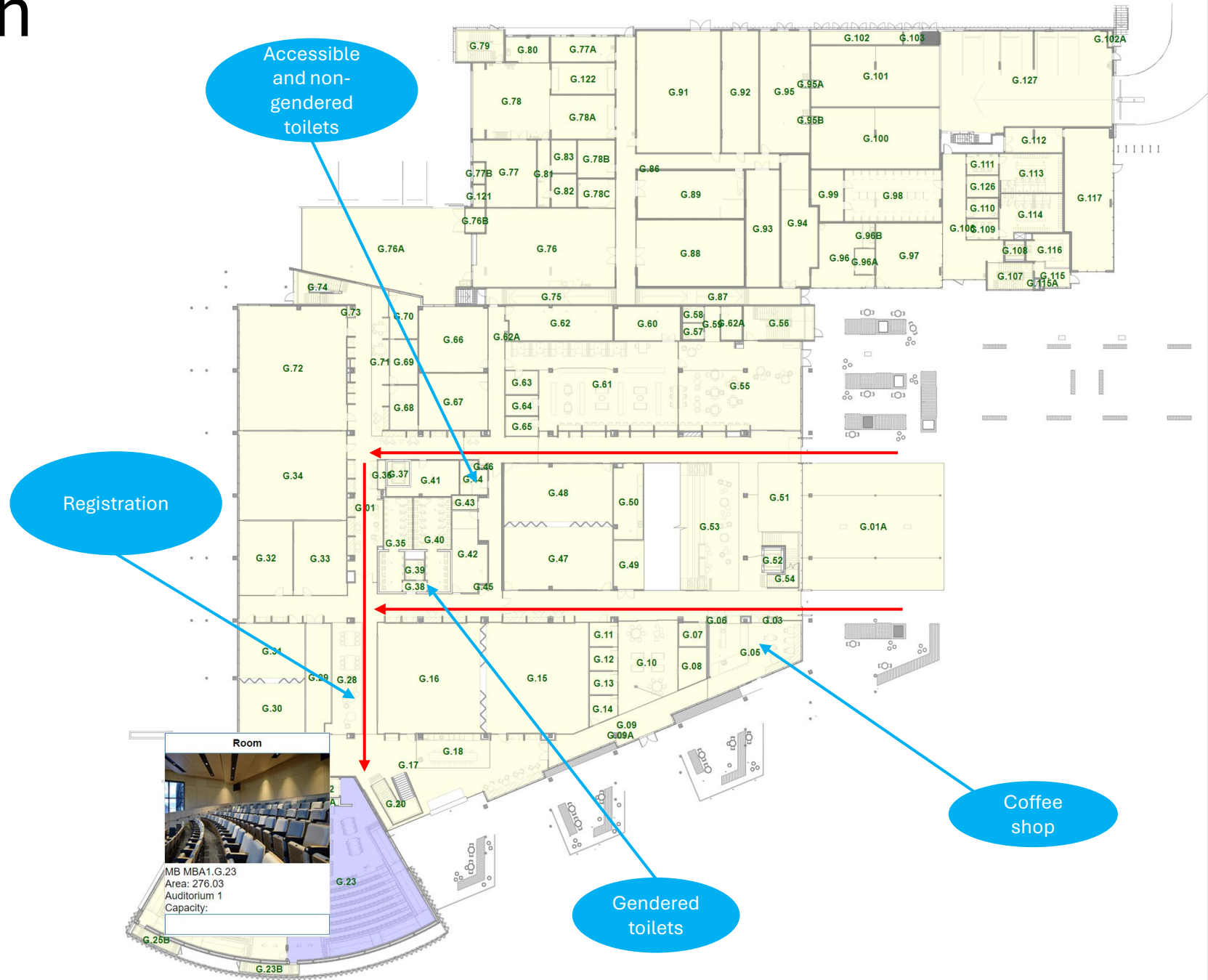

Amenities

- There are male, female, accessible and gender-neutral bathrooms close to the conference room.
- If you would like to access a quiet room, please see a member of the organising committee and we will be able to help you.
- Conference dedicated wi-fi is not available, but eduroam is.

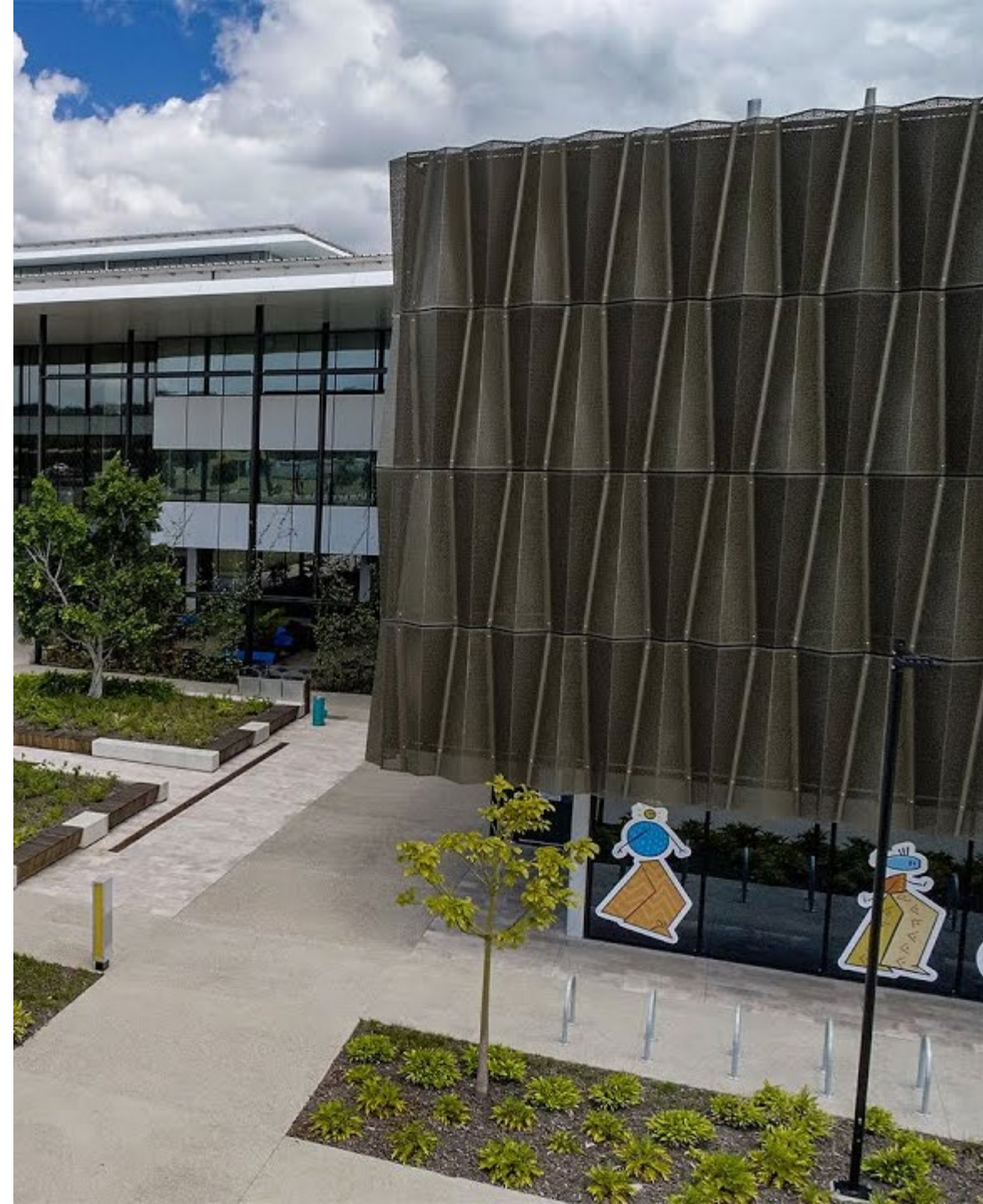

Food

- Morning tea and afternoon tea will be provided each day.
- Delegates will need to provide their own lunch.
- We looking into organising the ability to pre-order lunch and will provide more details as soon as possible.



Presenter Information

- If your submission is accepted, both extended abstract and practice track live presenters will need to prepare and submit their slides in advance of the conference.
- When presenting on the day, presenters will not be able to attach a laptop or use presenter mode. Please prepare accordingly.
- Online presenters will record their presentation and submit the recording in advance.
- All presenters, in-person and online, are expected to be present in their session for a live Q&A.
- Extended abstract presentations will be 15 minutes long. Practice track lightning talks will be 5 minutes long.





Practice Track Information

- Successful practice track presenters will need to supply all of their own equipment, computers and so on.
- The conference organisers take no responsibility for equipment or belongings that are left unattended by the owner.
- The practice track will be officially open during lunch each day of the conference.

Moreton Bay Sightseeing

- All good things, including DiGRAA 2026, must come to an end. But before you head home, there is a lot to see and explore in Moreton Bay. Here is a small sample of what the region has to offer.
- Bribie Island is a natural wonder. Check out [Visit Moreton Bay](#) and [Tourism and Events Queensland](#) for everything the island has to offer. There is everything from beaches to hikes to a butterfly house and museum! Don't have transport? Check out [G'day Adventure Tours](#).
- You don't need to go further north than Redcliffe if you are looking for lovely beaches. See more about what the Redcliffe has to offer [here](#) courtesy of Visit Moreton Bay. Did we mention the [dolphin cruise](#)?
- [Osprey House](#) is near Petrie and features boardwalks and nesting ospreys.
- For the ultimate inspiration guide, [explore Visit Moreton Bay's 50 things to do in the region](#).



Bribie Island. Source: Tourism and Events Queensland.



See You Soon